

Technical data sheet

CORDOFEU® 240 FIRESTOP EXPANSION JOINT

CORDOFEU® Firestop Expansion Joints have been manufactured in France for over 10 years now. They have undergone numerous fire resistance tests in the vertical and horizontal position with recognized and accredited laboratories in France. CORFOFEU® expansion joints are patented by the INPI under No. 1762113.

Fire resistance

The range of CORDOFEU® 240 fire resistant expansion joints complies with official regulations and standards :

- **Amended decree of March 22, 2004** : « Fire resistance of products, construction elements and works »
- **JO CE 2000/367/CE** (May 2000) : « Classification of fire resistance characteristics of construction products, construction works and parts thereof »
- **Standard EN 1366-4+A1** (June 2010) : « Fire resistance tests for service installations - Part 4: Linear joint seals »
- **Standard EN 13501-2** (June 2016) : « Fire classification of construction products and components - Part 2: Classification based on data from fire resistance tests excluding products used in ventilation systems »
- **Fire resistance rating :**
EI240 - H - M20 - B - W15 to 180
EI240 - V - M20 - B - W15 to 180
EI240 - T - M20 - B - W15 to 180



Composition

- Incombustible mineral wool
- Dustproof glass veil & glass fibre grid





Packaging

Reference	Diameter (mm)	Opening (mm)	Roll (ml)	Pallet (ml)	Movement (%)
CORDOFEU 240 - 15	15	10	50	5600	0/+20%
CORDOFEU 240 - 20	20	15	50	3200	
CORDOFEU 240 - 30	30	20	30	1890	
CORDOFEU 240 - 40	40	25	30	1080	
CORDOFEU 240 - 50	50	30	25	800	
CORDOFEU 240 - 60	60	40	25	500	
CORDOFEU 240 - 70	70	45	20	240	
CORDOFEU 240 - 80	80	50	20	240	
CORDOFEU 240 - 90	90	60	18	216	
CORDOFEU 240 - 100	100	70	10	160	
CORDOFEU 240 - 120	120	80	2 x 2	280	
CORDOFEU 240 - 150	150	100	2 x 2	192	
CORDOFEU 240 - 180	180	120	2 x 2	160	

CORDOFEU® 240 FIRESTOP EXPANSION JOINT



Accessories

Reference	Unit	Packaging	
Glue APROSIL60G/7	kg	Pot 7kg	
Connexion mat (0,25x10ml) FAS800-6-25	ml	Roll 10ml	

Quantity of glue & connection mats

Reference	Glue (g/ml)	Connection mats (ml/connection)
CORDOFEU 240 - 15	40	0,10
CORDOFEU 240 - 20	40	0,11
CORDOFEU 240 - 30	60	0,15
CORDOFEU 240 - 40	80	0,18
CORDOFEU 240 - 50	100	0,21
CORDOFEU 240 - 60	120	0,25
CORDOFEU 240 - 70	120	0,28
CORDOFEU 240 - 80	140	0,31
CORDOFEU 240 - 90	160	0,35
CORDOFEU 240 - 100	160	0,38
CORDOFEU 240 - 120	180	0,45
CORDOFEU 240 - 150	200	0,54
CORDOFEU 240 - 180	200	0,64

Compatibility



Support structure from 2 060 kg/m³



Protective and sealing mastic



Joint cover

Applications

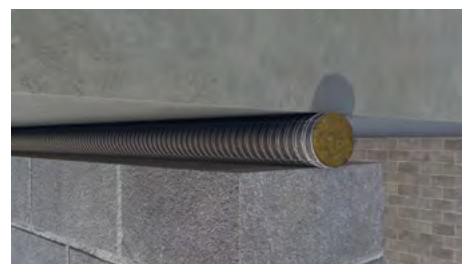

*THE VALUES MENTIONED OPPOSITE ARE GIVEN AS AN INDICATION AND CANNOT BE CONSIDERED AS ABSOLUTE.

EDITION DATE: 03/2023

Information & orders
contact@passitex.com

PASSITEX.COM